

# Jade sandwich counter

self contained

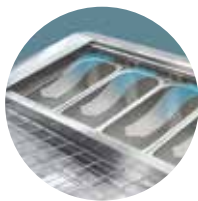

Electronic controller



Blown airwell



Removable air ducts



Removable cassette



10 Amp power

Our Australian made and designed sandwich counters are engineered to perform in the harshest environments that kitchens can dish up. They are designed to highlight your fresh ingredients while providing you quick access, a large preparation area and huge storage space for the busiest kitchen.



## Advantages

- High ambient rating for hard working environments
- Coolsmart electronic controller for energy efficiency and even temperatures
- Fully enclosed stainless steel well under food pans—prevents food from dropping into cabinet
- Square glass canopy
- Polypropylene cutting board (10 mm thick)
- One plastic coated shelf per door
- Refrigerated blown air over and under ALL pans—maximizes food holding capacity and refrigeration efficiency
- Removable blown air ducts for easy cleaning
- Polycarbonate sliding lids over blown air well
- Stainless worktop
- Self closing solid doors
- Forced air refrigeration system contained in a removable cassette for easy servicing and maintenance
- Waste heat recovery vaporiser system—no need for external drain
- Longer life anti corrosive evaporator coil coating
- Swivel and brake castors
- Threaded castors allow simple leg changeover if required
- Designed and built to international quality standards for reliability and performance—HACCP compliant
- Face mounted hinges for plinth mounting

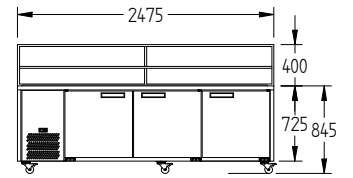
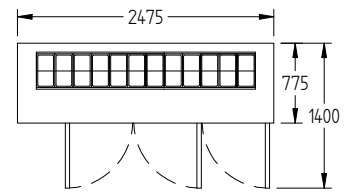
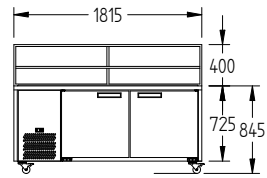
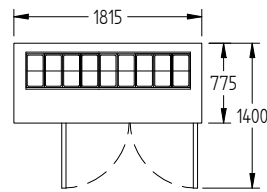
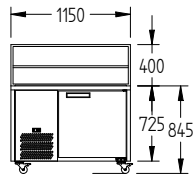
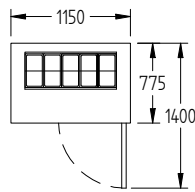
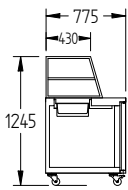

MODEL		1 DOOR	2 DOOR	3 DOOR
H (Refrigerator +1°/+4°C)	White	<b>HJ1SCBA</b>	<b>HJ2SCBA</b>	<b>HJ3SCBA</b>
H (Refrigerator +1°/+4°C)	Stainless Steel	<b>HJ1SCBASS</b>	<b>HJ2SCBASS</b>	<b>HJ3SCBASS</b>

## SPECIFICATIONS

<b>CAPACITY LITRES</b>		250	500	750
<b>GN PANS 100 MM DEEP (INCLUDED)</b>		10 X 1/6	18 X 1/6	24 X 1/6
<b>DIMENSIONS - W X D X H (ON CASTORS) MM</b>		1150 W x 775 D x 845 H	1815 W x 775 D x 845 H	2475 W x 775 D x 845 H
<b>WEIGHT UNPACKED (KG)</b>		160	210	240

## STANDARD INCLUSIONS \*\*\*

### DOOR TYPE

Standard: **SD** (Solid Door) Optional: **DR** (Drawer)

### FINISH (INTERIOR & EXTERIOR EXCLUDING UNDER. STAINLESS STEEL INTERNAL FLOOR & PREP AREA)

**CB** (White), **CBB** (Black), **SS** (Stainless Steel)

### SHELVES/DOOR

1

1

1

## ELECTRICAL

<b>POWER SUPPLY</b>		10 amp	10 amp	10 amp
<b>FRIDGE MODELS</b>	<b>RUNNING AMPS</b>	3.8	4.8	4.8

## GAS TYPE

<b>REFRIGERANT</b>	<b>SELF CONTAINED</b>	R134a	R134a	R134a
	<b>REMOTE</b>	R404a	R404a	R404a

## REFRIGERATION WATTAGES FOR OPTIONAL REMOTE UNITS

<b>REMOTE WATTAGES</b>	600 @ -10°C SST	750 @ -10°C SST	980 @ -10°C SST
------------------------	-----------------	-----------------	-----------------

\*\*\* For **Jade sandwich counter OPTIONS** see page 47

Prices do not include GST. Prices and specifications are subject to change without notice.